



ADVANTAGES GUIDE

Robotic Pool Cleaners



8109024

maytronics

Dolphin principals of operation

Driving & steering

Dolphin robots drive on two brushes that are connected by sturdy tracks and a robust robotic drive system to the motor unit which provides the motion and steering power to the Robot. The drive and steering system ensures optimal maneuverability in any pool condition, including around common obstacles.

Scanning system

The Dolphin scanning system is powered by intelligent software that detects processes and learns the various parameters of the pool, throughout the cleaning cycle, this enables optimal coverage without stalling near the walls and without wasting cleaning time. The software allows sharp changes in direction, ensuring the Dolphin reaches into every area and corner of the pool.

- **Floor-only models**

The robot is designed to work 100% of the cycle time on thoroughly cleaning the entire floor area. This includes the critical areas where the floor and walls meet, where dirt tends to accumulate.

- **Climbing models**

The robot is designed to optimally distribute cleaning time between the pool floor, walls and waterline, so that each part is worked on for the maximum time required for complete and thorough cleaning.

Dolphin principals of operation

Dolphin principals of operation

Brushing system

The brushing system is composed of two or three brushes, depending on the model.

- **Principles**

Rapid brush rotation is vital to effective cleaning. The third brush (installed in select Dolphin models) rotates at double the speed of the robot's movement, providing extra-rigorous brushing and scrubbing. Brushes scrub the pool floor, corners, walls and waterline – effectively removing algae and bacteria colonies.

Dolphin robots utilize several types of brush to enable optimal cleaning of different pool types:

- **PVC**

Suitable for vinyl, PVC and unglazed concrete pools.

- **Combined brushes (CB)**

Suitable for vinyl, PVC and unglazed concrete pools as well as pools lined with fiberglass, rough ceramics, Marbelite and stainless steel.

- **Wonder brushes (WB)**

Suitable for pools lined with smooth ceramic tiles.

Dolphin principals of operation

Dolphin principals of operation

Filtration system

- **Suction principals**

Water is sucked into the bottom of the robot by a powerful pump. Dirt particles of all sizes are captured by the filtering system; and clean water flows out of the robot and back to the pool.

Two filtering levels – ultra-fine and rough – address different needs. This provides efficient and effective cleaning according to pool conditions, geographical area and season.

There are two different filter configurations: filter bag and cartridge.

- **Models with a filter bag**

With its large surface area of specially constructed fabric, the filter bag is highly efficient at catching a large volume of debris and dirt, including small dust particles, without becoming clogged. This enables efficient cleaning throughout the cycle.

- **Models with cartridges and spring net**

Four large filter cartridges effectively trap dirt and dust. The lightweight construction makes it easy to insert/remove and clean the cartridges and nets.

Dolphin principals of operation

Dolphin principals of operation

Dolphin overview

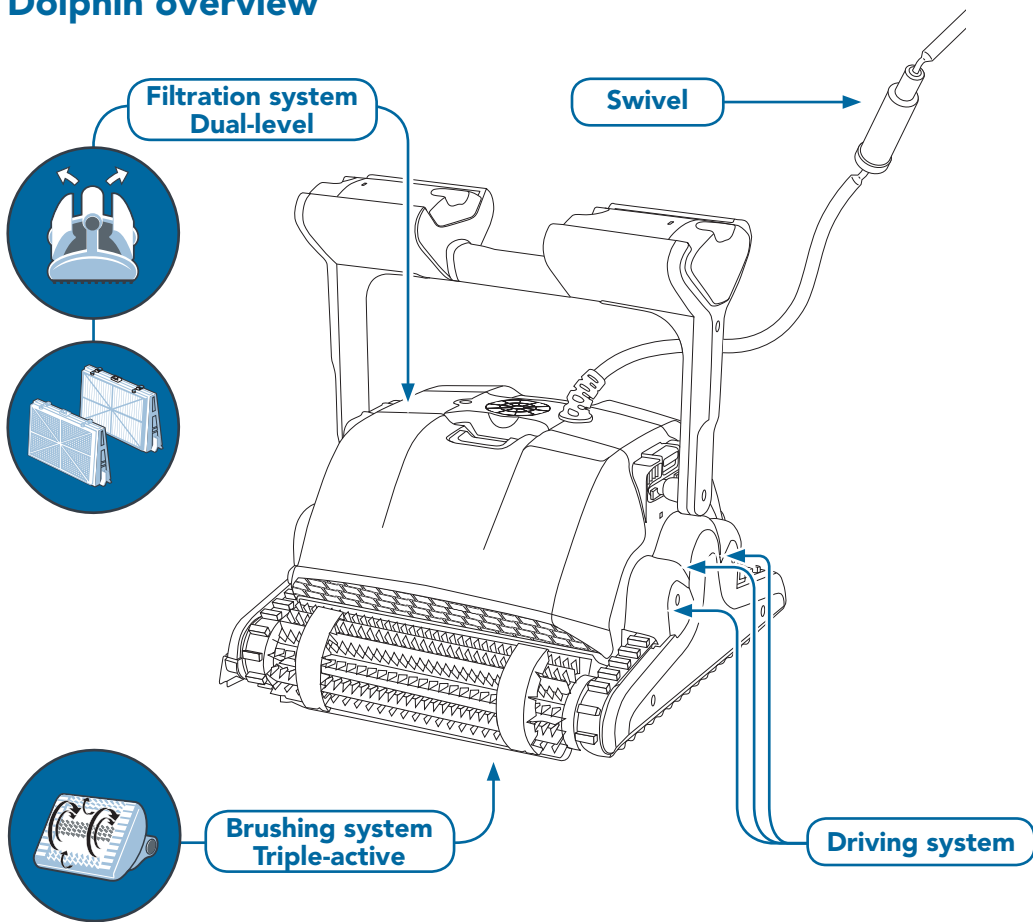

Dolphin principals of operation

Why a Dolphin robot pool cleaner?

Experience

The pioneer of robotic pool cleaners. Established in 1983

Only Dolphin robotic pool cleaners by Maytronics deliver a complete, exceptional pool experience. Building on decades of expertise in automated pool cleaning, every Dolphin robot combines advanced technologies with proven reliability to ensure maximum satisfaction, every time.

Superior pool cleaning performance

- **Pool coverage**

The Dolphin smart scanning algorithm is designed to ensure optimized coverage for any pool size or shape, including beach entry pools.

- **Brushing**

Effective brushing system eliminates algae and bacteria from the pool floor, corners, walls and waterline.

- **Dirt collection**

The Dolphin is equipped with a powerful and efficient suction system that optimizes the collection of rough debris and fine dirt particles without clogging, leaving the entire pool surface clean and crystal clear.

Why a Dolphin robot pool cleaner?

Why a Dolphin robot pool cleaner?

Motor Unit (MU) protection system

- **Overload**
Automatic MU protection shutdown in case when an external object (e.x goggles) blocks the drive system.
- **Out of water**
Automatic MU protection shutdown in case where the Dolphin drives outside the water (beach entry, top stairs).
- **Obstacle escape**
Automated mechanism that senses when the Dolphin is stuck (ex. under the pool stairs) and activates a special escape drive mode.

Benefits

Only Dolphin robotic pool cleaners by Maytronics deliver an automated high-performance pool cleaning in minimum time with maximum cleaning effectiveness.

Why a Dolphin robot pool cleaner?

Why a Dolphin robot pool cleaner?

Unique features

- **Swivel**

Only Dolphin robotic pool cleaners come standard with a unique, patented swivel device that prevents the cable from creasing or tangling. The robot moves freely with no need for manual intervention to untwist the cable.

- **DIY servicing**

Snap-in/out brush replacement.

Dolphin robots are designed for DIY repair by dealers. Generally within several minutes the Dolphin can be disassembled, analyzed with a dedicated DIY tester, repaired and assembled and ready to use.

We welcome you to approach your local distributor and get more information on how to become a certified DIY repair dealer.

- **Top access**

Easy access to filtration system allows easy cleaning maintenance operation (Available in selected model).

Warranty policy

The only brand in the market that grants full Warranty on all parts for the longest duration (2 years for floor only and 3 years for climbing models).

Why a Dolphin robot pool cleaner?

Models information

Dolphin Supreme M3



Features and advantages

Recommended for pools up to 12m in length.

Cleans pool floor including the angles where the floor meets the walls.

Scanning – Optimal pool coverage throughout the cycle time.
Obstacle escape mechanism.

Brushing – Dual-active brushing, high cleaning performance.
Reinforced removal of algae and bacteria leaves the pool water pure and clean.
Significantly reduces the need for chemicals.

Filtration – Fine filter bag collects fine dust particles and rough debris.

Models information

Models information

Dolphin Supreme M3

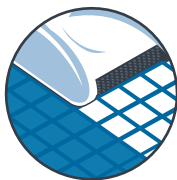

Active-brushing

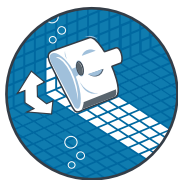

Cleans pool floor and the angle where the floor meets the walls



Powerful filtration system

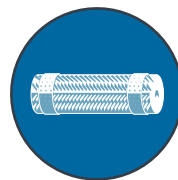

All-surface brushes

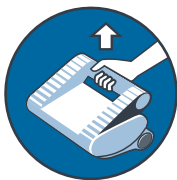

DIY
Repairable at
dealer level

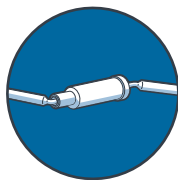

Swivel on cable
prevents cable
tangling

Product specifications:

- Cable – 18m
- Swivel – Prevents cable tangling
- Cycle time – 3 hours
- Digital switch-mode power supply – Output 30 VDC, IP 54
- Stand for storage
- Combined brushes – All-surface brushes
- Warranty – 24 months on all parts

Models information

Models information

Dolphin Supreme M4



Features and advantages

Recommended for pools up to 12m in length.

Cleans pool floor, walls and waterline.

Scanning – Optimal pool coverage throughout the cycle time.
Obstacle escape mechanism.

Brushing – Triple-Active brushing, the third brush rotates at double the speed, reinforcing the high cleaning performance and completely removing all algae and bacteria, leaving the pool water pure and clean.
Significantly reduces the need for chemicals.

Filtration – Top-access for easy and convenient maintenance.

- Dual-level filtration system covers all pool conditions.
- Ultra-fine cartridge for day-to-day cleaning collects fine dust particles.
- Net for leaves and rough debris.

Models information

Models information

Dolphin Supreme M4

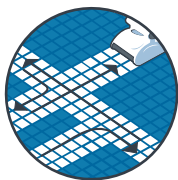

Complete pool scanning



Triple-active brushing

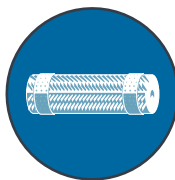

All-surface brushes

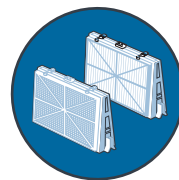

Dual-level filtration options for fine and rough dirt

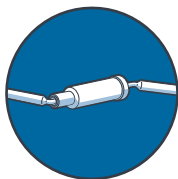

Swivel on cable prevents cable tangling



Top-access

Product specifications:

- Cable – 18m
- Swivel – Prevents cable tangling
- Cycle time – 2.5 hours
- Digital switch-mode power supply – Output 30 VDC, IP 54
- Caddy for storage and handling
- Combined brushes – All-surface climbing brushes
- Warranty – 36 months on all part

Models information

Models information

Dolphin Supreme M5



Features and advantages

Recommended for pools up to 15m in length.

Cleans pool floor, walls and waterline.

Scanning – Optimal pool coverage throughout the cycle time.
Obstacle escape mechanism.

Brushing – Triple-Active brushing, the third brush rotates at double the speed, reinforcing the high cleaning performance and completely removing all algae and bacteria, leaving the pool water pure and clean.
Significantly reduces the need for chemicals.

Filtration – Top-access for easy and convenient maintenance.

- Dual-level filtration system covers all pool conditions.
- Ultra-fine cartridge for day-to-day cleaning collects fine dust particles.
- Net for leaves and rough debris.

Additional features – Remote control with choice of cleaning programs, operation delay and manual navigation.

Digital switch-mode power supply with full filter bag indicator.

Models information

Models information

Dolphin Supreme M5



Complete pool scanning



Triple-active brushing

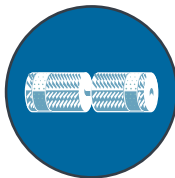

Dual-motor
All-surface brushes

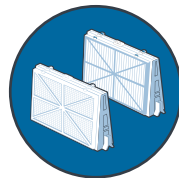

Dual-level filtration
options for fine
and rough dirt



Top-access

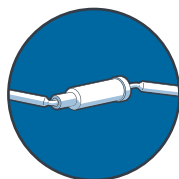

Swivel on cable
prevents cable
tangling



Remote control
set-up of parameters
and cleaning programs

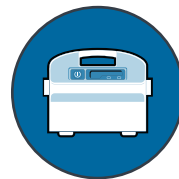

Full filter indicator,
operation delay

Product specifications:

- Cable – 18m
- Swivel – Prevents cable tangling
- Cycle time – 1.5/2.5/3.5 hours
- Digital switch-mode power supply – Output 30 VDC, IP 54 with full filter bag indicator and operation delay
- Caddy for storage and handling
- Combined brushes – All-surface climbing brushes
- Remote control for touch-guided navigation, setting parameters and cleaning programs
- Warranty – 36 months on all parts

Models information

Useful operation hints

For optimal operation, instruct your customer to check that the water temperature, pH and chlorine conform to the following recommended levels:

- pH: 7.0 – 7.8
- Chlorine: max 4 ppm / Na Cl 5000 ppm
- Temp.: 6° – 34°C

Quick answers to common customer questions

How should I set up the Dolphin for operation?

1. Connect the cable to the power supply, ensuring the power supply is positioned at least 3m from the pool's edge and is in the shade.
CAUTION: Never use an extension cable.
2. Release the minimum required floating cable length to ensure entire pool coverage. Leave excess cable coiled outside the pool.
3. Place the Dolphin in the pool. For models with combined brushes (CB) or wonder brushes (WB), squeeze the brushes until they are soaked with water.

How should I clean the Dolphin?

After each cleaning cycle, wash the filter bag or cartridge under running water. Clogged filters reduce scanning and cleaning efficiency. Once every two months, wash the filter bag (M3 only) in a washing machine using a regular synthetic wash cycle.

How should I store the Dolphin?

After each cleaning cycle, take the Dolphin out of the water and store away from direct sunlight, excessive heat or frost, to prevent accelerated wear and tear on plastic parts. Store the Dolphin in a shady place on its Caddy or stand or, if not on the Caddy/stand, place the Dolphin upside down.

Useful operation hints

Basic troubleshooting

| Problem | Solution |
|---|---|
| Pool cleaner does not move | <ol style="list-style-type: none">1. Check that the power supply is plugged in, and that the plug attached to the power supply is connected properly.2. Turn the power supply off, wait 30 seconds, then turn it back on.3. Unplug the power supply, open the impeller top cover and check that nothing is trapped in the impeller. |
| The pool cleaner moves but does not clean the pool | <ol style="list-style-type: none">1. Clean the filter bag/cartridge if blocked.2. Check that nothing is trapped in the impeller. (Note: Unplug the power supply before checking the impeller). |
| The pool cleaner cleans only part of the pool | <ol style="list-style-type: none">1. Check that there is sufficient slack in the cable for the pool cleaner to reach the entire pool. (Excess cable should be coiled on the Caddy or laid out alongside the pool).2. Check the brushes to see if they are obstructed or worn out.3. Clean the filter bag/cartridge. |
| The pool cleaner floats instead of sitting on the pool floor | <ol style="list-style-type: none">1. Try removing the air.2. With the pool cleaner in the water, squeeze the brushes to make sure that they are completely soaked with water. |



Useful operation hints

Useful operation hints

Basic troubleshooting

| Problem | Solution |
|--|--|
| Cable has kinks | To remove the kinks, stretch the cable out completely and let it sit in the sun for a day. |
| The pool cleaner does not climb walls | <ol style="list-style-type: none">1. Clean the filter bag/cartridge.2. Check the level of chemicals in the water. Improper levels may allow algae to grow, resulting in slippery walls. If this is the case, adjust the chemical levels and scrub the walls.3. Check that the brushes are not worn out.4. In models with a remote control, check that the robot is in wall climbing mode. |

Useful operation hints

Useful operation hints

Service policy

Dolphin after-sales service commitment

Maytronics, the company behind all Dolphin robotic pool cleaners, is dedicated to providing all customers fast, professional, cost-effective and efficient service.

We believe in supporting your ability to deliver highly effective first-line response to your customers:

- Self-diagnostics – Enable instant, onsite diagnoses of problems.
- Full repair instructions and interactive repair tools – Reduce service time.
- Analyzer tool – For all motor units, power supplies, cables, remote control units
- Professional technician education – Customized training and certification at distributors' facilities; annual technical seminars.
- Ongoing support from Maytronics local distributor.

Our service standards and expectations:

- Repair time should not exceed 7 days repair cycle time.
- Bumper to bumper assurance, full warranty on all parts.
- Availability of spare parts at your local distributor service center.
- Annual product training – Coordinate with your local distributor.
- Hot line support provided by your local distributor.

DIY quick guide

Level 1:

Snap in/out brushes replacement

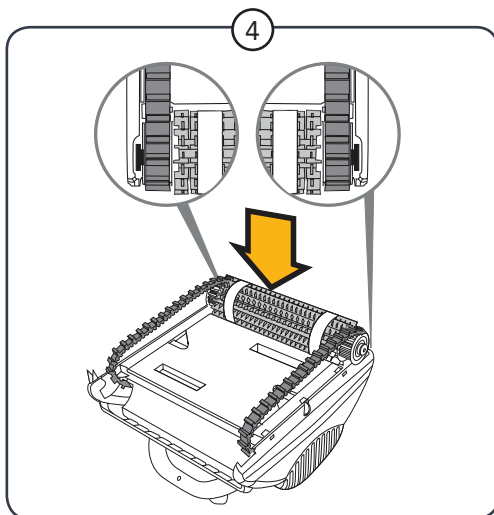
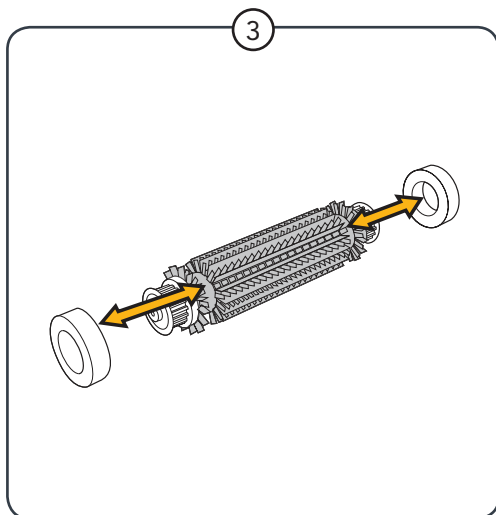
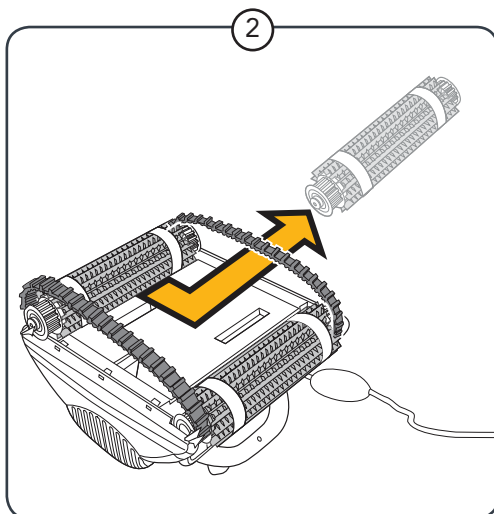
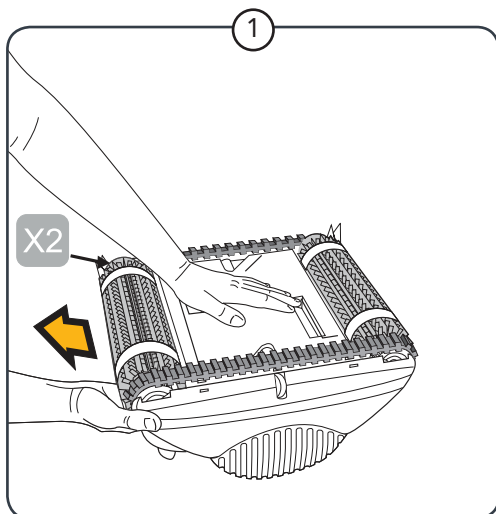

DIY quick guide

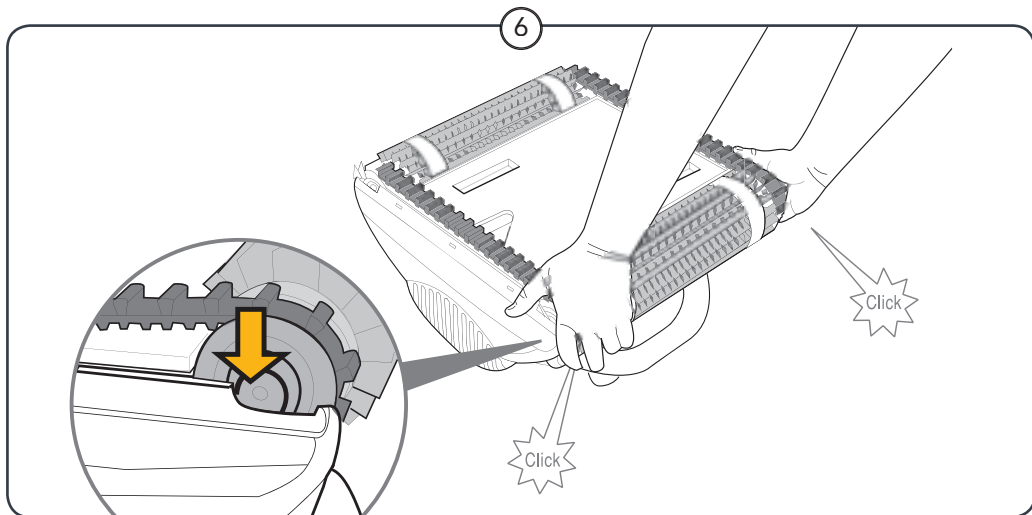
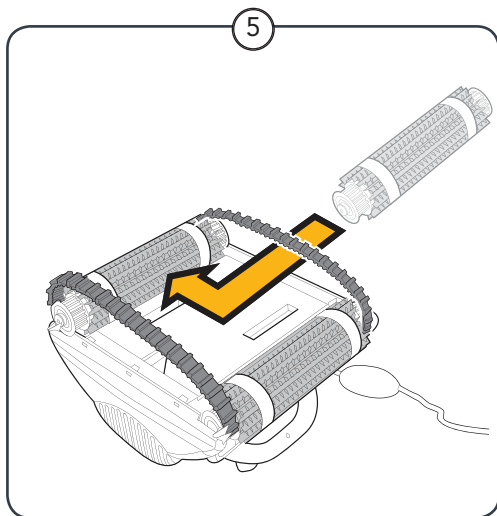

DIY quick guide

Level 2:

Repair and parts replacement of all the Dolphin parts.

Dolphin robots are designed for DIY repair. Generally within several minutes the Dolphin can be disassembled, analyzed with a dedicated DIY tester, repaired, reassembled and ready for use.

We welcome you to approach your local distributor and to receive more information on how to become a certified DIY repair dealer.