

How to replace the cell

- 1 Unplug power cord or turn off the breaker

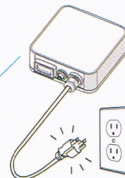

- 2 Close off water valves around the tee (if applicable)

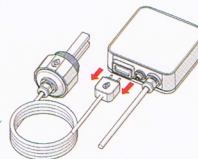

- 3 Unplug cell from the controller

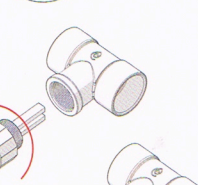

- 4 Unscrew cell from the tee

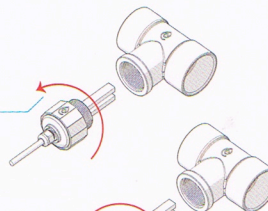

- 5 Screw the new cell into the tee until it is hand tight. Orient the bars such that the water flows between them (or as close as possible with no leaking). Use the included o-ring to help with orientation if needed.

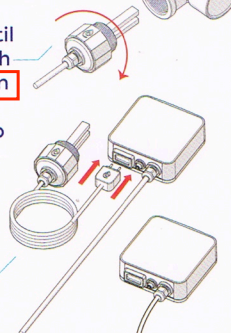

- 6 Plug cell into controller (new cells have only two pins, this is ok)

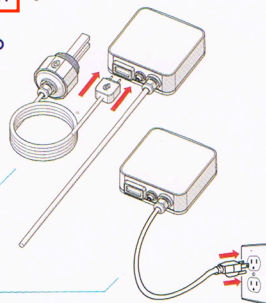

- 7 Power controller back up

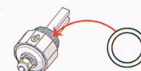

Note

If your new cell does not fit into the tee, try the extra o-ring supplied to fill the gap. If this does not work, email support@mineralpools.com for a new tee to be sent for free.